

GENIT 3002



Specifications

Engine

- John Deere 4045 Diesel Engine
- 4.5L Turbo Charged
- CA EPA Certified
- Fuel Consumption 1.5 gallons per hour

Fuel Tank

- 100 gallon capacity #2 diesel only
- Frame integral dual wall construction

Trailer

- Electric brakes
- Light weight weather resistant aluminum enclosure
- Heavy Duty Axle rated for 10,000 lbs.
- Trailer Weight estimated at only 6,750 lbs. (dry weight)
- Measurements – 192”L x 76”W x 108”H

Auxiliary Power

- Two 480 volt 100amp Ac breakers
- Other power configurations available upon request

Power Rating

125 KW @ 20% Duty Cycle

GENIT 3002 is so GREEN !

- **Save 50% on Energy Consumption.**
- **50% Less Fuel Consumption**
- **CA EPA Certified Engines**
- **Estimated at only 6750 lbs**

Inverter Stud Welder Specifications

Model IT3002

Weld range: #4 to 1” Diameter

Duty cycle: 3/4” diameter @ 12 studs per min

Welding current: 2600 A

Extremely easy to operate

Portable at only 353 lbs

Gun retriggering lockout

System Includes :

(1) TWE 17000 heavy duty Stud Gun

(2) 50 ft 4/0 ground cable with clamp.

(1) 75 ft 4/0 twin gun cable

*** Single gun or dual gun option

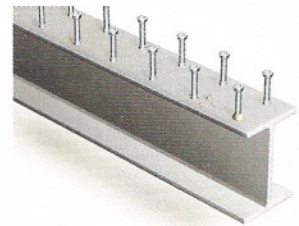
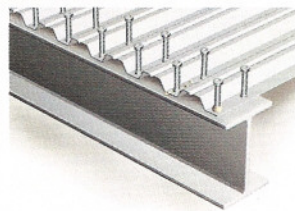
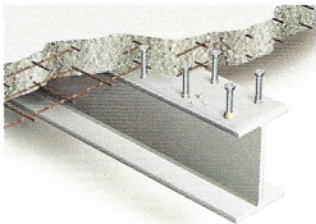

Stud Welding Products, Inc—Los Angeles—San Francisco—Seattle—Phoenix—800-252-1919